

BOS

homogenisers

MG₂

High-Pressure homogeniser
Model MG2

Pressures up to 800 bar
Capacities from 30 to 1300 l/h



The homogenising valve

Available in a variety of designs and materials, single or two stage, with the standard flat homogenising valve and seat in Rexalloy®™ but also with a serrated surface (LW type) or Knife Edge geometry for cell rupture applications. Each type specially designed to achieve the highest efficiency with the lowest energy consumption. The different valve designs are available in the standard Rexalloy®™ material, Tungsten Carbide and Ceramic. The homogenising pressures are manually adjusted.

The cylinder block

A single piece precision machined block made out of a high tensile, corrosion resistant, forged stainless steel. Built with top flanges only providing easy access for inspection and maintenance. The standard design has ceramic plungers and integrated water cooling. The fully sanitary design utilises a minimum of parts and seals and is suitable for C.I.P.

Besides the standard spherical and ball type pump valves, always with field replaceable pump valve seats there are many other options available to meet specific product or process requirements.

The drive end

The one piece high strength drive with splash lubrication provides a quiet running machine. The drive end does not require cooling water. The machine is standard executed with a frequency converter for capacity variations of between 30-100% under full load. The electric motor is pre-wired in combination with an integrated frequency converter.

Two stage homogenising valve

A typical two stage hand operated homogenising valve assembly with a plug type valve in the first stage and a pilot type valve in the second stage.

This assembly meets the highest demand for C.I.P. cleaning, is easily accessible for maintenance and uses a minimum of parts.

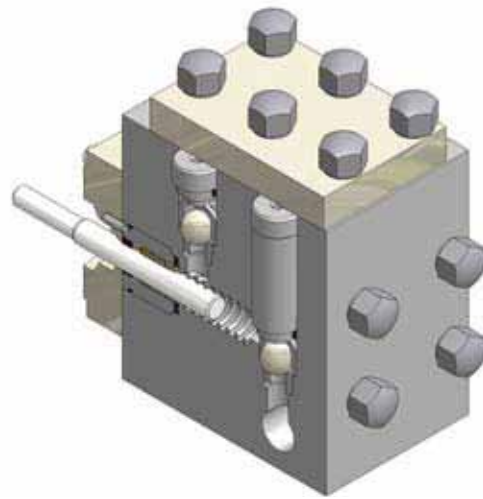
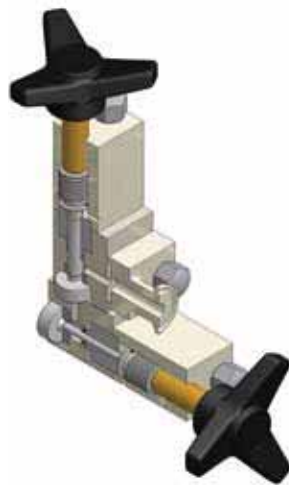

The pump block is a one piece precision machined block, made

out of high strength corrosion resistant forged stainless steel. The one piece design utilises a minimum of parts and seals, is fully sanitary and suitable for C.I.P.

MG2 PERFORMANCE TABLE

MG2 with BALL TYPE pump valves for high viscosity/ abrasive products and products containing solids				MG2 with SPHERICAL TYPE pump valves for low viscose and low abrasive products		
Machine type	Maximum capacity	Eccentric shaft speed	Operating pressure	Machine type	Maximum capacity	Eccentric shaft speed
MG2-800B	90 l/h	223 rpm	800 bar			
MG2-600B	120 l/h	207 rpm	600 bar			
MG2-500B	145 l/h	213 rpm	500 bar			
MG2-400B	180 l/h	228 rpm	400 bar	MG2-400S	450 l/h	552 rpm
MG2-350B	210 l/h	204 rpm	350 bar	MG2-350S	520 l/h	489 rpm
MG2-275B	260 l/h	199 rpm	275 bar	MG2-275S	700 l/h	520 rpm
MG2-200B	350 l/h	217 rpm	200 bar	MG2-200S	900 l/h	541 rpm
MG2-175B	400 l/h	205 rpm	175 bar	MG2-175S	1050 l/h	522 rpm
MG2-150B	475 l/h	205 rpm	150 bar	MG2-150S	1200 l/h	501 rpm
MG2-140B	500 l/h	199 rpm	140 bar	MG2-140S	1300 l/h	500 rpm

Weight 175 kg

